



**LICENSING ACT 2003  
PREMISES LICENCE**

Cyngor Sir **Ceredigion** County Council



**s licence number**

**PRM 0255 (Issued 06/02/2020)**

**Premises details**

**Postal address of premises, or if none, ordnance survey map reference or description**

**RUMMERS WINE BAR,  
TREFECHAN BRIDGE, BRIDGE STREET,**

**Post town**

**ABERYSTWYTH**

**Post code**

**SY23 1XD**

**Telephone number**

**01970 625 177**

**Where the licence is time limited the dates**

**LICENCE NOT TIME LIMITED**

**Licensable activities authorised by the licence**

**REGULATED ENTERTAINMENT:**

**LIVE MUSIC**

**RECORDED MUSIC**

**LATE NIGHT REFRESHMENT**

**SALE BY RETAIL OF ALCOHOL**

**The times the licence authorises the carrying out of licensable activities**

**REGULATED ENTERTAINMENT:**

**LIVE MUSIC: MON-SUN: 1100-0200 HRS**

**RECORDED MUSIC: SUN-THUR: 1100-0200 HRS. FRI and SAT: 1100-0300 HRS**

**LATE NIGHT REFRESHMENT: MON-SUN: 2300-0200 HRS**

**SALE BY RETAIL OF ALCOHOL: SUN-THUR: 1100-0200 HRS. FRI and SAT: 1100-0300 HRS**

**NON STANDARD TIMINGS:**

**NEW YEARS EVE: From the commencement of hours on New Years Eve to conclusion of hours on New Years Day.**

**The opening hours of the premises**

**SUN-THUR: 1100-0230 HRS. FRI and SAT: 1100-0330 HRS.**

**NEW YEARS EVE: From commencement of hours on New Years Eve to conclusion of hours on New Years Day.**

**Where the licence authorises supplies of alcohol whether these are on and/or off supplies**

**ON AND OFF SALES**

**Name, (registered) address, telephone number and email (where relevant) of holder of premises licence**

**LONDON & MIDLAND LTD  
THE OAKLEY  
KIDDERMINSTER RD  
DROITWICH  
WORCESTER  
WR9 9AY**

**Registered number of holder, for example company number, charity number (where applicable)**

**05644454**

**Name, address and telephone number of designated premises supervisor where the premises licence authorises the supply of alcohol**

**MARCUS EDWARD SEDGHI**

**Personal licence number and issuing authority of personal licence held by designated premises supervisor where the premises licence authorises for the supply of alcohol**

**CER 1361**

**CEREDIGION COUNTY COUNCIL**

## **Annex 1 - MANDATORY CONDITIONS**

### **1 Mandatory conditions where licence authorises supply of alcohol**

(1) Where a premises licence authorises the supply of alcohol, the licence must include the following conditions.

(2) The first condition is that no supply of alcohol may be made under the premises licence-

(a) at a time when there is no designated premises supervisor in respect of the premises licence, or

(b) at a time when the designated premises supervisor does not hold a personal licence or his personal licence is suspended.

(3) The second condition is that every supply of alcohol under the premises licence

must be made or authorised by a person who holds a personal licence.

### **2 Mandatory condition: exhibition of films**

(1) Where a premises licence authorises the exhibition of films, the licence must include a condition requiring the admission of children to the exhibition of any film to be restricted in accordance with this section.

(2) Where the film classification body is specified in the licence, unless subsection

(3)(b) applies, admission of children must be restricted in accordance with any recommendation made by that body.

(3) Where-

(a) the film classification body is not specified in the licence, or

(b) the relevant licensing authority has notified the holder of the licence that this subsection applies to the film in question, admission of children must be restricted in accordance with any recommendation made by that licensing authority.

(4) In this section-

"children" means persons aged under 18; and

"film classification body" means the person or persons designated as the authority under section 4 of the Video Recordings Act 1984 (c.39) (authority to determine suitability of video works for classification).

### **3 Mandatory condition: door supervision**

(1) Where a premises licence includes a condition that at specified times one or more individuals must be at the premises to carry out a security activity, the licence

must include a condition that each such individual must be licensed by the Security Industry Authority.

- (2) But nothing in subsection (1) requires such a condition to be imposed-
- (a) in respect of premises within paragraph 8(3)(a) of Schedule 2 to the Private Security Industry Act 2001 (c.12) (premises with premises licences authorising plays or films), or
  - (b) in respect of premises in relation to-
    - (i) any occasion mentioned in paragraph 8(3)(b) or (c) of that Schedule (premises being used exclusively by club with club premises certificate, under a temporary event notice authorising plays or films or under a gaming licence), or
    - (ii) any occasion within paragraph 8(3)(d) of that Schedule (occasions prescribed by regulations under that Act).
- (3) For the purposes of this section-
- (a) "security activity" means an activity to which paragraph 2(1)(a) of that Schedule applies, and
  - (b) paragraph 8(5) of that Schedule (interpretation of references to an occasion) applies as it applies in relation to paragraph 8 of that Schedule.

## **The Licensing Act 2003 (Mandatory Licensing Conditions) Order 2014**

**With effect from 28<sup>th</sup> May 2014**

1. A relevant person shall ensure that no alcohol is sold or supplied for consumption on or off the premises for a price which is less than the permitted price.
2. For the purposes of the condition set out in paragraph 1-
  - (a) “duty” is to be construed in accordance with the Alcoholic Liquor Duties Act 1979;
  - (b) “permitted price” is the price found by applying the formula –
$$P = D + (D \times V)$$
where –
    - (i) P is the permitted price
    - (ii) D is the rate of duty chargeable in relation to the alcohol as if the duty were charged on the date of the sale or supply of the alcohol, and
    - (iii) V is the rate of value added tax chargeable in relation to the alcohol as if the value added tax were charged on the date of the sale or supply of the alcohol
  - (c) “relevant person” means, in relation to premises in respect of which there is in force a premises licence –
    - (i) The holder of the premises licence,
    - (ii) The designated premises supervisor (if any) in respect of such a licence, or
    - (iii) The personal licence holder who makes or authorises a supply of alcohol under such a licence;
  - (d) “relevant person” means, in relation to premises in respect of which there is in force a club premises certificate, any member or officer of the club present on the premises in a capacity which enables the member or officer to prevent the supply in question; and
  - (e) “valued added tax” means value added tax charged in accordance with the Value Added Tax Act 1994

3. Where the permitted price given by Paragraph (b) of paragraph 2 would (apart from this paragraph) not be a whole number of pennies, the price given by that sub-paragraph shall be taken to be the price actually given by that sub-paragraph rounded up to the nearest penny.
4. (1) Sub-paragraph (2) applies where the permitted price by Paragraph (b) of paragraph 2 on a day ("the first day") would be different from the permitted price on the next day ("the second day") as a result of a change to the rate of duty or value added tax.  
  
(2) The permitted price which would apply on the first day applies to sales or supplies of alcohol which take place before the expiry of the period of 14 days beginning on the second day.

The Licensing Act 2003 (Mandatory Licensing Conditions) (Amendment) Order  
2014

The below Mandatory Conditions **replace** the Licensing Act 2003 (Mandatory Licensing Conditions) Order 2010 and comes into effect **on 1<sup>st</sup> October 2014**

**Conditions 1 to 4 refer to all premises that sell or supply alcohol for consumption on the premises. Condition 3 is relevant to Premises that sell for consumption off the premises.**

1. (1) The responsible person must ensure that staff on relevant premises do not carry out, arrange or participate in any irresponsible promotions in relation to the premises.

(2) In this paragraph, an irresponsible promotion means any one or more of the following activities, or substantially similar activities, carried on for the purpose of encouraging the sale or supply of alcohol for consumption on the premises—

(a) games or other activities which require or encourage, or are designed to require or encourage, individuals to—

(i) drink a quantity of alcohol within a time limit (other than to drink alcohol sold or supplied on the premises before the cessation of the period in which the responsible person is authorised to sell or supply alcohol), or

(ii) drink as much alcohol as possible (whether within a time limit or otherwise);

(b) provision of unlimited or unspecified quantities of alcohol free or for a fixed or discounted fee to the public or to a group defined by a particular characteristic in a manner which carries a significant risk of undermining a licensing objective;

(c) provision of free or discounted alcohol or any other thing as a prize to encourage or reward the purchase and consumption of alcohol over a period of 24 hours or less in a manner which carries a significant risk of undermining a licensing objective;

(d) selling or supplying alcohol in association with promotional posters or flyers on, or in the vicinity of, the premises which can reasonably be considered to condone, encourage or glamorise anti-social behaviour or to refer to the effects of drunkenness in any favourable manner;

(e) dispensing alcohol directly by one person into the mouth of another (other than where that other person is unable to drink without assistance by reason of disability).



**2.** The responsible person must ensure that free potable water is provided on request to customers where it is reasonably available.

**3. (1)** The premises licence holder or club premises certificate holder must ensure that an age verification policy is adopted in respect of the premises in relation to the sale or supply of alcohol.

(2) The designated premises supervisor in relation to the premises licence must ensure that the supply of alcohol at the premises is carried on in accordance with the age verification policy.

(3) The policy must require individuals who appear to the responsible person to be under 18 years of age (or such older age as may be specified in the policy) to produce on request, before being served alcohol, identification bearing their photograph, date of birth and either—

(a) a holographic mark, or

(b) an ultraviolet feature.

**4.** The responsible person must ensure that—

(a) where any of the following alcoholic drinks is sold or supplied for consumption on the premises (other than alcoholic drinks sold or supplied having been made up in advance ready for sale or supply in a securely closed container) it is available to customers in the following measures—

(i) beer or cider: ½ pint;

(ii) gin, rum, vodka or whisky: 25 ml or 35 ml; and

(iii) still wine in a glass: 125 ml;

(b) these measures are displayed in a menu, price list or other printed material which is available to customers on the premises; and

(c) where a customer does not in relation to a sale of alcohol specify the quantity of alcohol to be sold, the customer is made aware that these measures are available.”

## **Annex 2 - Conditions consistent with the operating Schedule**

**Premises Licence is subject to Embedded Conditions converted under Licensing Act 1964 with exception of conditions contained in Special Hours Certificate.**

### **Promotion of Licensing Objectives**

#### **a) General**

The upper ground floor area will operate as a lounge bar with an emphasis on the provision of food, cocktails and wine. Whereas the existing licensed lower ground floor area has 13 separate beers the upper ground floor area will have only 3 beers on draught. The operating intention is that some customers will resort to the upper ground floor lounge bar to eat or enjoy wine or cocktails before perhaps resorting to live entertainment on the lower ground floor when that is taking place. The lounge bar area will be occupied predominantly by tables with table service of food etc. There will be limited standing room. Live music taking place in the lower ground floor area will be 'piped' or streamed to the lounge bar area, because it will be heard in the upper ground floor area in any event. Rather than have a muffled sound from the lower ground floor area, using microphones the live music sound can be reproduced as a clear sound in the upper ground floor area but with the volume controlled. Other than this reproduced sound there will be no independent regulated entertainment in the upper ground floor area. The flat/residential accommodation shown on the plan of the upper ground floor area will not be used at all in connection with licensed activities. The variation will not add in any substantial or significant way to the cumulative impact of existing licensed premises as these premises have been associated with licensable activities for many years. Although the applicant wishes to have the flexibility of the timings set out in the existing operating schedule with regard to opening times and service of alcohol, it is anticipated that generally the use of the upper ground floor area will rarely extend beyond midnight.

#### **b) The prevention of crime and disorder**

##### **Door supervisors**

Whenever regulated entertainment event involving music and dancing is taking place on the premises, the premises will have two door supervisors for every 100 persons in the premises (downstairs) or part thereof, and they shall be on duty from the time of commencement of the regulated entertainment event until the regulated entertainment event terminated. Whenever regulated entertainment event involving music and dancing is taking place on the premises, the premises will have two door supervisor for every 100 persons in the premises or part thereof, and they shall be on duty from the time of commencement of the regulated entertainment event until the regulated entertainment event terminated.

No door supervisors for the upper ground floor as no independent regulated entertainment will be taking place in the upper ground floor area.

**CCTV**

CCTV is installed and working on the premises

Notice will be displayed at the entrance to the premises advising customers that CCTV is in operation

CCTV to be to Dyfed Powys Police minimum standards

**Bottles and glasses**

Customers carrying open or sealed bottles or glasses are not admitted to the premises at any time

Customers are not permitted to take open containers of alcoholic or soft drinks from the premises

Regular sweeps of public areas are made to remove finished or empty bottles or glasses

**Drinks promotions**

All inclusive nights or other irresponsible drinks promotions are not permitted

**Drugs**

Any instances of illegal drug use or suspected illegal drug use will be reported to the Police

A secure facility is available on the premises to store any controlled drugs found on the premises prior to collection by the Police

**Notices**

Notices are displayed on the premises advising customers that if they act in an inappropriate manner they could be barred from the premises an all licensed premises in the vicinity.

Any restrictions on the admission of children and young persons to the premises are to be displayed outside the premises.

**Behave Or Be Banned Scheme**

Will be an active member of the BOBB Scheme

**c) Public safety**

**Door supervisors**

One door supervisor will be used when regulated entertainment (other than background music) is taking place at the premises from 21:00 to 02:40 or until the premises close if earlier

**CCTV**

CCTV is installed and working on the premises

Notice will be displayed at the entrance to the premises advising customers that CCTV is in operation

CCTV to be to Dyfed Powys Police minimum standards

**Bottles and glasses**

Customers carrying open or sealed bottles or glasses are not admitted to the premises at any time

Customers are not permitted to take open containers of alcoholic or soft drinks from the premises

Regular sweeps of public areas are made to remove finished or empty bottles or glasses

**Drinks promotions**

All inclusive nights or other irresponsible drinks promotions are not permitted

**Drugs**

Any instances of illegal drug use or suspected illegal drug use will be reported to the Police

A secure facility is available on the premises to store any controlled drugs found on the premises prior to collection by the Police

**Notices**

Notices are displayed on the premises advising customers that if they act in an inappropriate manner they could be barred from the premises an all licensed premises in the vicinity.

Any restrictions on the admission of children and young persons to the premises are to be displayed outside the premises.

**First Aid**

Adequate and appropriate first aid equipment and materials are available on the premises, located in the kitchen.

**Special effects**

Use of special effects is not permitted on the premises.

Special effects means:

- Dry ice machines and cryogenic fog
- Smoke machines and fog generators
- Pyrotechnics, including fireworks
- Real flames
- Firearms
- Motor vehicles
- Strobe lighting
- Lasers
- Explosives and highly flammable substances

**Behave Or Be Banned Scheme**

Will be an active member of the BOBB Scheme

Fire Safety

Will abide by current Fire Regulations

**d) The prevention of public nuisance**

Regulated entertainment limited to downstairs premises only

The windows in the downstairs premises are kept shut during regulated entertainment to limit the breakout of noise

Prominent, clear and legible notices are displayed at all exits requesting patrons to respect the needs of local residents and to the leave the premises and area quietly.

The applicant does not permit the use of explosive, pyrotechnics and fireworks or effects of a similar nature which could cause disturbances to nearby properties.

The placing of bottles into receptacles outside the premises is only permitted to take place between the hours of 0900hrs and 1700hrs to minimise disturbance to nearby properties.

The playing of live or recorded music in the beer garden area of the premises is not permitted.

**Noxious smells**

Ventilation and extract systems are designed and maintained so as to prevent noxious smells causing a nuisance to nearby properties.

Refuse receptacles are cleaned with disinfectant.

**Light pollution**

The premises do not use flashing lights outside the premises, any security or access lighting is installed or operated so as not to cause a nuisance to nearby properties.

**Litter**

The premise has a waste collection contract with Ceredigion County Council who remove waste twice a week.

**e) The protection of children from harm**

The premises have clear signs explaining restrictions on the admission of children and young persons under the age of 18 years.

The hours of the day during which age restrictions apply are between 2100hrs and 0340hrs.

Children are admitted to the premises before 2100 provided they are supervised by a person 18 years or over and for this purpose supervision means present in the same area of the premises as the child under supervision, children are not permitted to be present on the premises after 2100hrs.

Will operate a challenge 21 Policy

### **Annex 3 - Conditions attached after a hearing by the licensing authority/ Mediation meeting**

**MEDIATION AGREEMENT:** Contained in a letter dated 13.9.05 from Applicants Solicitor, Morris and Bates in response to representations received by Pc John EVANS, Police Licensing Officer.

**The following matters were agreed:**

**Door supervisions:** Whenever regulated entertainment event involving music and dancing is taking place on the premises, the premises will have two door supervisor for every 100 persons in the premises or part thereof, and they shall be on duty from the time of commencement of the regulated entertainment event until the regulated entertainment event terminated.

**Public safety:** The applicant will inform his insurers of the new hours under the new Operating Schedule, and our client has accepted that advice, and there is no need for any condition to be inserted in the Operating Schedule.

**Stop entry time:** It is agreed that there shall not be a stop entry time for the premises

**Hours for the supply of alcohol/public present on the premises:** The hours for the supply of alcohol will be until 0200hrs every weekday, and until 0300hrs Friday night to Saturday morning to 0300hrs Saturday night to Sunday morning. The drinking up time shall be 30 minutes; therefore the public may be present on the premises until 0230hrs during the week and until 0300hrs Fridays and Saturday nights.

**MEDIATION MEETING on the 10<sup>th</sup> October 2016, following Full Variation application 20/09/2016, between:**

**Eifion Roberts (Environmental Control)**

**Sgt Charles Weller (Heddlu Dyfed Powys Police)**

**PCSO Mary Weller (Heddlu Dyfed Powys Police)**

**Catrin Davies (Assistant Licensing Officer – Cyngor Sir Ceredigion Council)**

**David Hinton-Jones (Morris & Bates Solicitors)**

**Mr Huw Richard Roberts (Applicant)**

**Mrs Jane Roberts (Wife of Applicant)**

**The following matters were agreed:**

- Regulated entertainment limited to downstairs premises only
- Regular sweeps of public areas are made to remove finished or empty bottles or glasses – To be re-instated on Premises Licence
- Two door supervisors for every 100 persons in the premises or part thereof. (Already on Premises Licence but to be included on Annex 2 – Operating Schedule)
- Will be an active member of BOBB Scheme
- Will operate a Challenge 21 Policy
- Will abide by current Fire Regulations
- The windows in the downstairs premises to be kept shut during regulated entertainment to limit the break out of noise
- CCTV to be to Dyfed Powys Police minimum standards

# Annex 4 – Plans

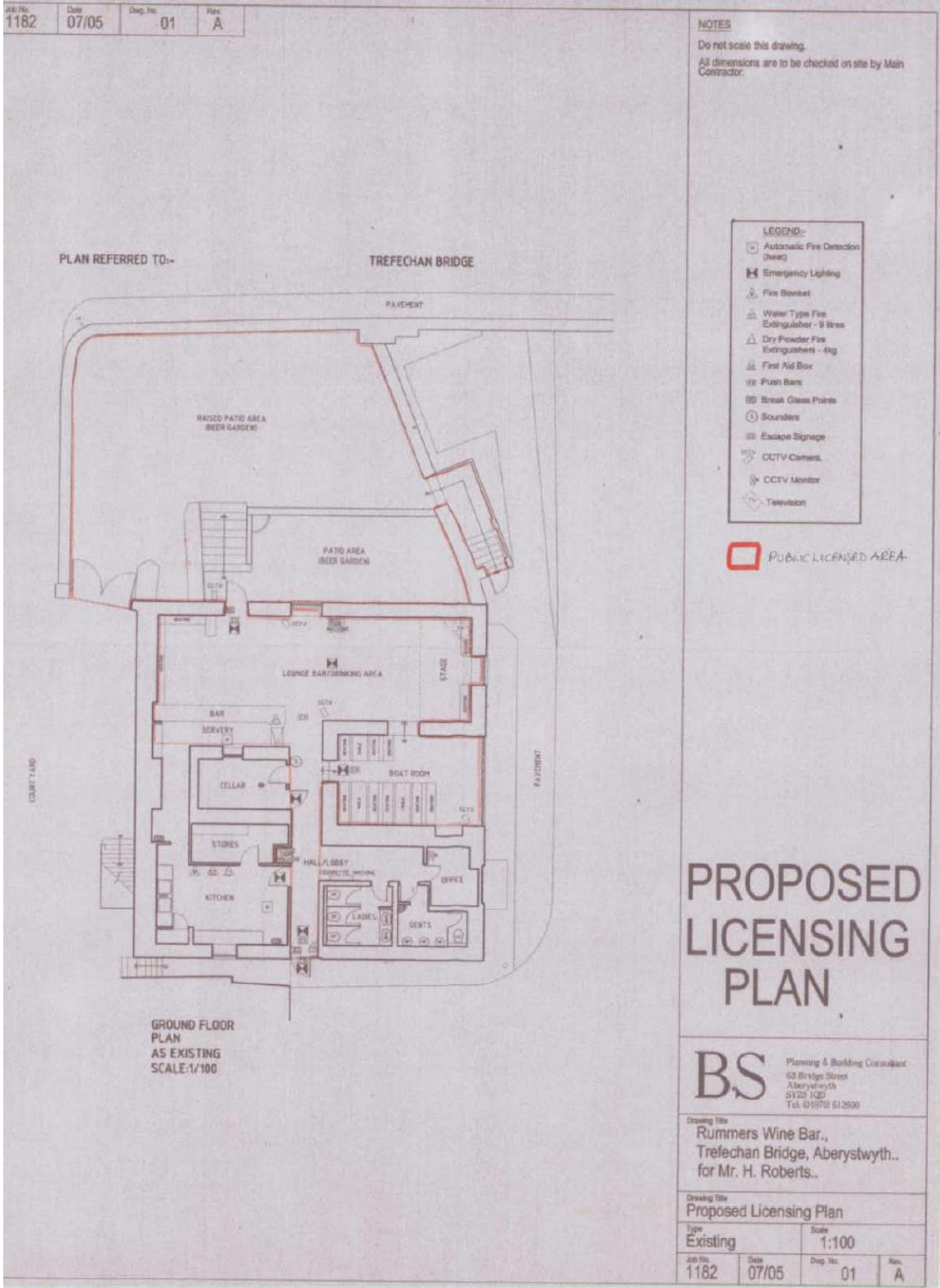



# PLAN REFERRED TO:-

## TREFECHAN BRIDGE

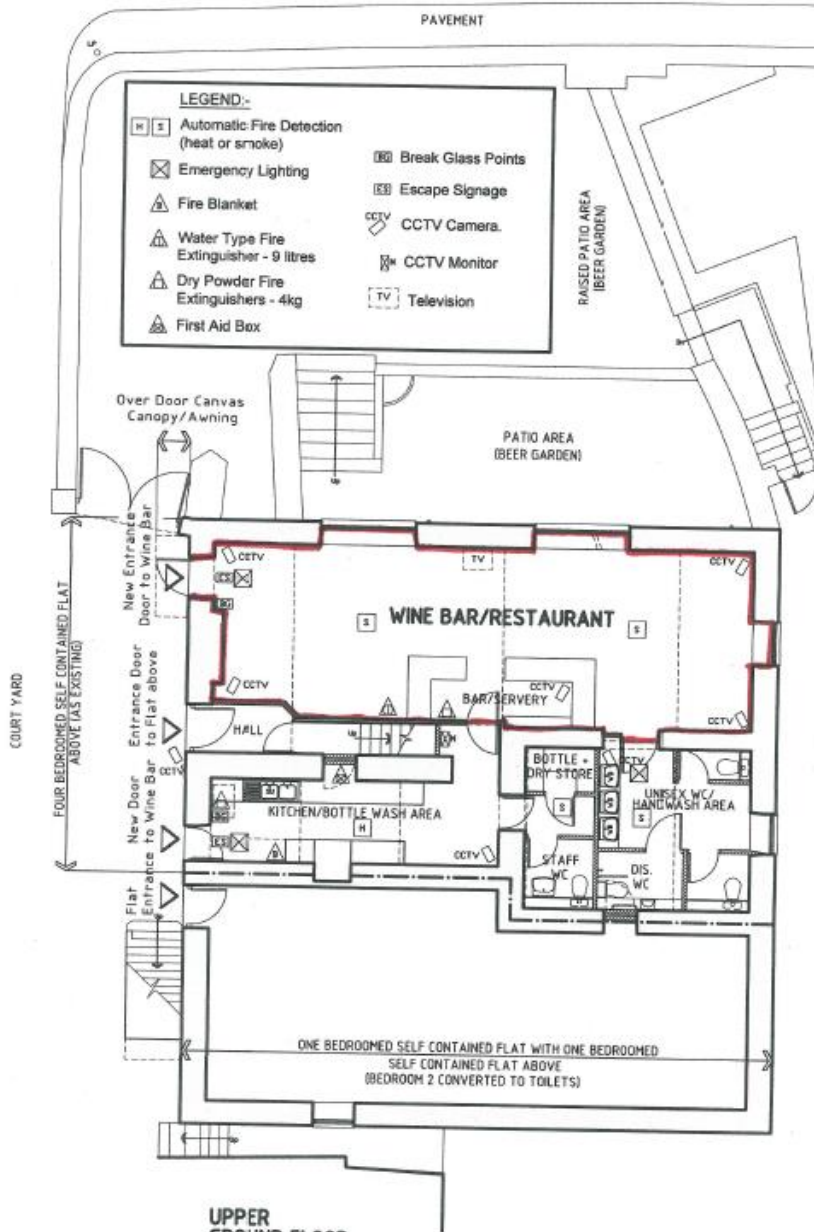

**UPPER  
GROUND FLOOR  
PLAN  
AS PROPOSED  
SCALE:1/100 @ A3**