

TRAFFIC MANAGEMENT NOTES:
 1) All temporary traffic management shall be in accordance with Chapter 8 of the Traffic Signs Manual.
 2) All temporary traffic management shall be in accordance with the Traffic Signs Regulations and General Directions 2016.
 3) All temporary traffic management shall conform to the Safety at Street Works and Road Works, A Code of Practice.
 4) All signing should be located 450mm minimum from any carriageway.
 5) All temporary traffic management sign locations are indicative and are subject to on site approval from the Engineer.

Key

- Traffic sign
- Traffic cone
- Pedestrian barrier
- Cone lamp
- Diversion route
- Road closure

Checked by: Adrian Crees	
Customer: MWS LTD	
Job reference: 96734017	
Location: PENRHIW ABERAERON Ceredigion SA46 0FA	QR Code:
Date: 21/01/2025	
Description: Road Closure	
Scale: NTS	OS HA: 0
0330 043 3030 www.corehighways.com	
Produced by: Ash Williams	
Design reference: ADW/21.01.25/J131389	
<small>This Design is subject to Copyright and remains the property of Core Highways. Contains Ordnance Survey data.</small>	



Sign Schedule

Sign Schedule



ID: 001 Qty: 2 Ref: 2703
Diverted traffic
Size: 1112 x 731 @ 75 X-hgt



ID: 013 Qty: 2 Ref: 7010.1
Nature of temporary hazard ahead - Road Closed
Size: 782 x 788 @ 75 X-hgt



ID: 002 Qty: 3 Ref: 2704
Diverted traffic
Size: 1130 x 731 @ 75 X-hgt



ID: 003 Qty: 3 Ref: 2704
Diverted traffic
Size: 1130 x 731 @ 75 X-hgt



ID: 004 Qty: 2 Ref: 2703
Diverted traffic
Size: 1112 x 731 @ 75 X-hgt



ID: 005 Qty: 4 Ref: 2703
Diverted traffic
Size: 962 x 731 @ 75 X-hgt



ID: 006 Qty: 2 Ref: 2702
Diversion Ends
Size: 1050 x 1000

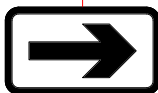

ID: 007 Qty: 3 Ref: 573
Direction to hazard right
Size: 600 x 400 @ 100 X-Hgt

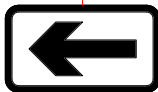

ID: 008 Qty: 3 Ref: 573
Direction to hazard left
Size: 600 x 400 @ 100 X-Hgt



ID: 009 Qty: 6 Ref: 7001
Road works ahead
Size: 750 High



ID: 010 Qty: 6 Ref: 7010.1
Nature of temporary hazard ahead - Road Ahead Closed
Size: 1176 x 938 @ 75 X-hgt



ID: 011 Qty: 2 Ref: 2702
Diversion
Size: 1050 x 1000



ID: 012 Qty: 2 Ref: 2702
Diversion
Size: 1050 x 1000



Information Boards to be taken to site and placed at either end of works

TRAFFIC MANAGEMENT NOTES:
1) All temporary traffic management shall be in accordance with Chapter 8 of the Traffic Signs Manual.
2) All temporary traffic management shall be in accordance with the Traffic Signs Regulations and General Directions 2016.
3) All temporary traffic management shall conform to the Safety at Street Works and Road Works, A Code of Practice.
4) All signing should be located 450mm minimum from any carriageway.
5) All temporary traffic management sign locations are indicative and are subject to on site approval from the Engineer.

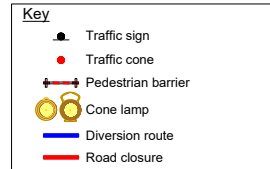

Checked by: Adrian Crees

Customer: MWS LTD

Job reference: 96734017

Location: PENRHIW
ABERAERON
Ceredigion
SA46 0FA



Date: 21/01/2025

Description: Road Closure

Scale: NTS OS HA: 0

0330 043 3030
www.corehighways.com

Produced by: Ash Williams

Design reference: ADW/21.01.25/J131389

This Design is subject to Copyright and remains the property of Core Highways.
Contains Ordnance Survey data.

