

SECTION B

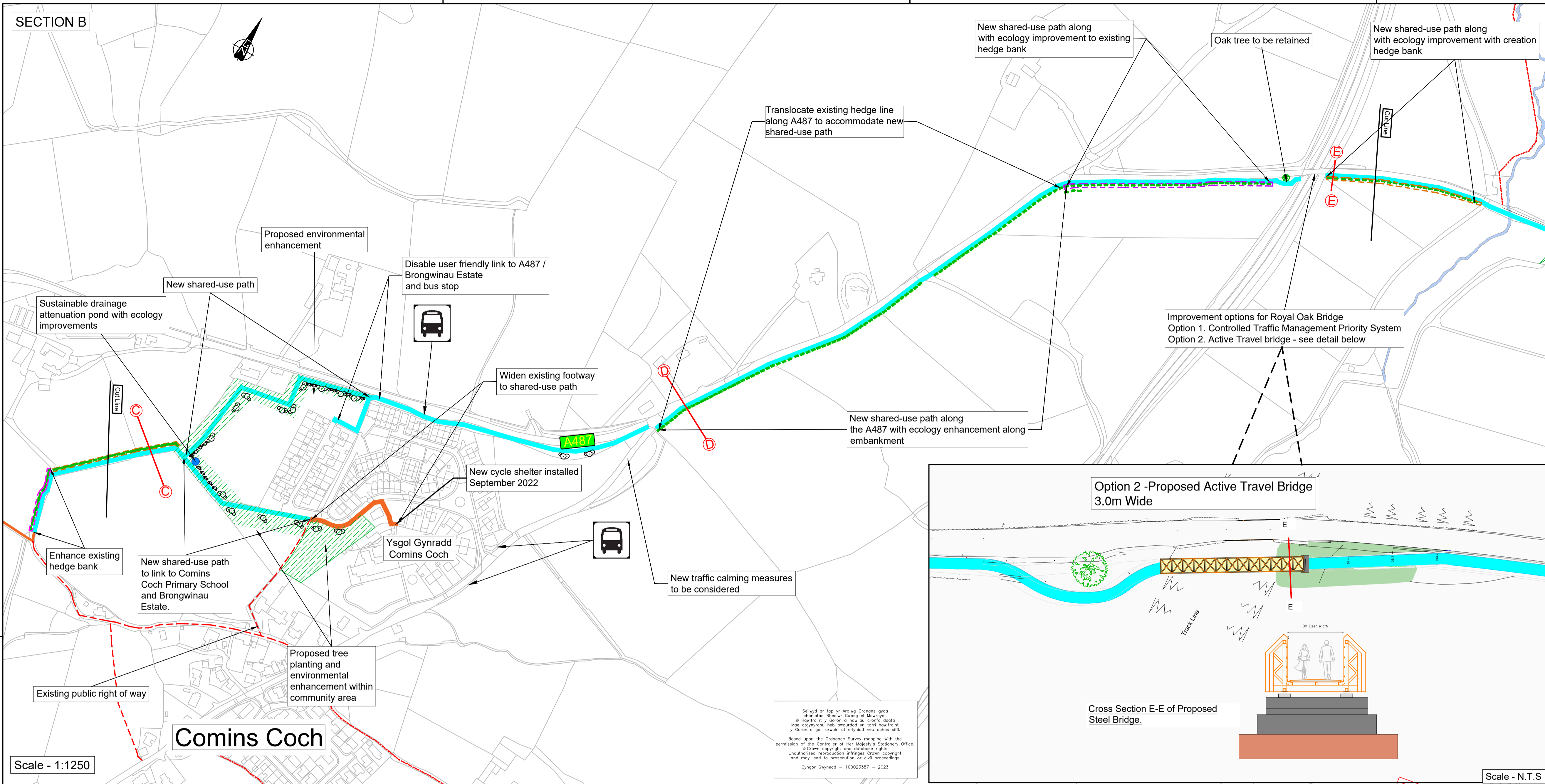

Scale - 1:1250

Comins Coch

Selwyd or fap yr Arloeg Odrwngs gyda rhwydwaith Rheolwr Gwelyd ei Mawrdd. © Hwffordd y Goron a Ffônau Cymru 2022. Nid ogyrchu heb eiddoedd yn torri hysbysu y Goron a goll arwein at eiddoedd neu achos sifft.
 Based upon the Ordnance Survey mapping with the permission of the Controller of Her Majesty's Stationery Office. © Crown copyright and database rights. Unauthorised reproduction infringes Crown copyright and may lead to prosecution or civil proceedings.
 Cynllun Gwynedd - 100023587 - 2023

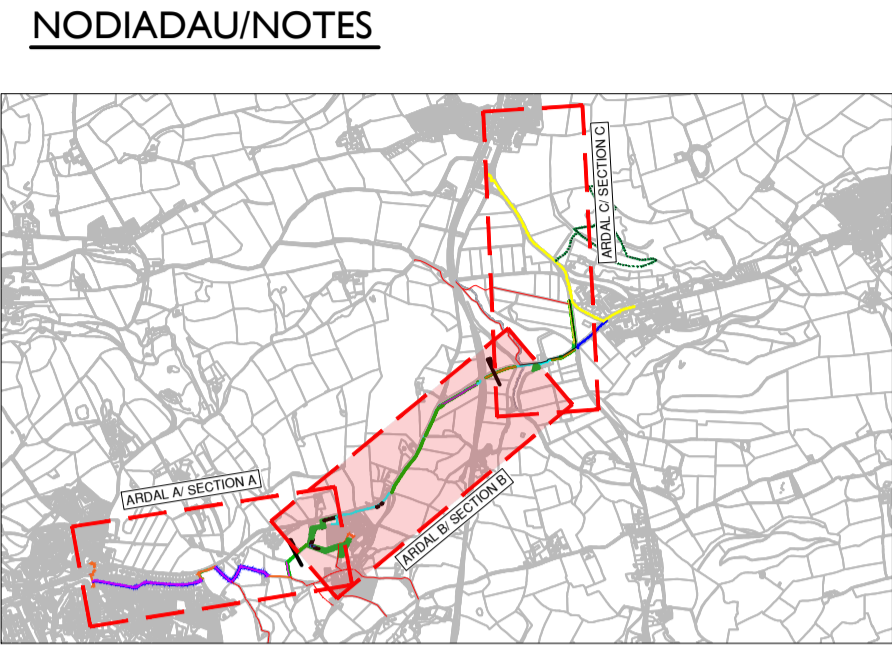
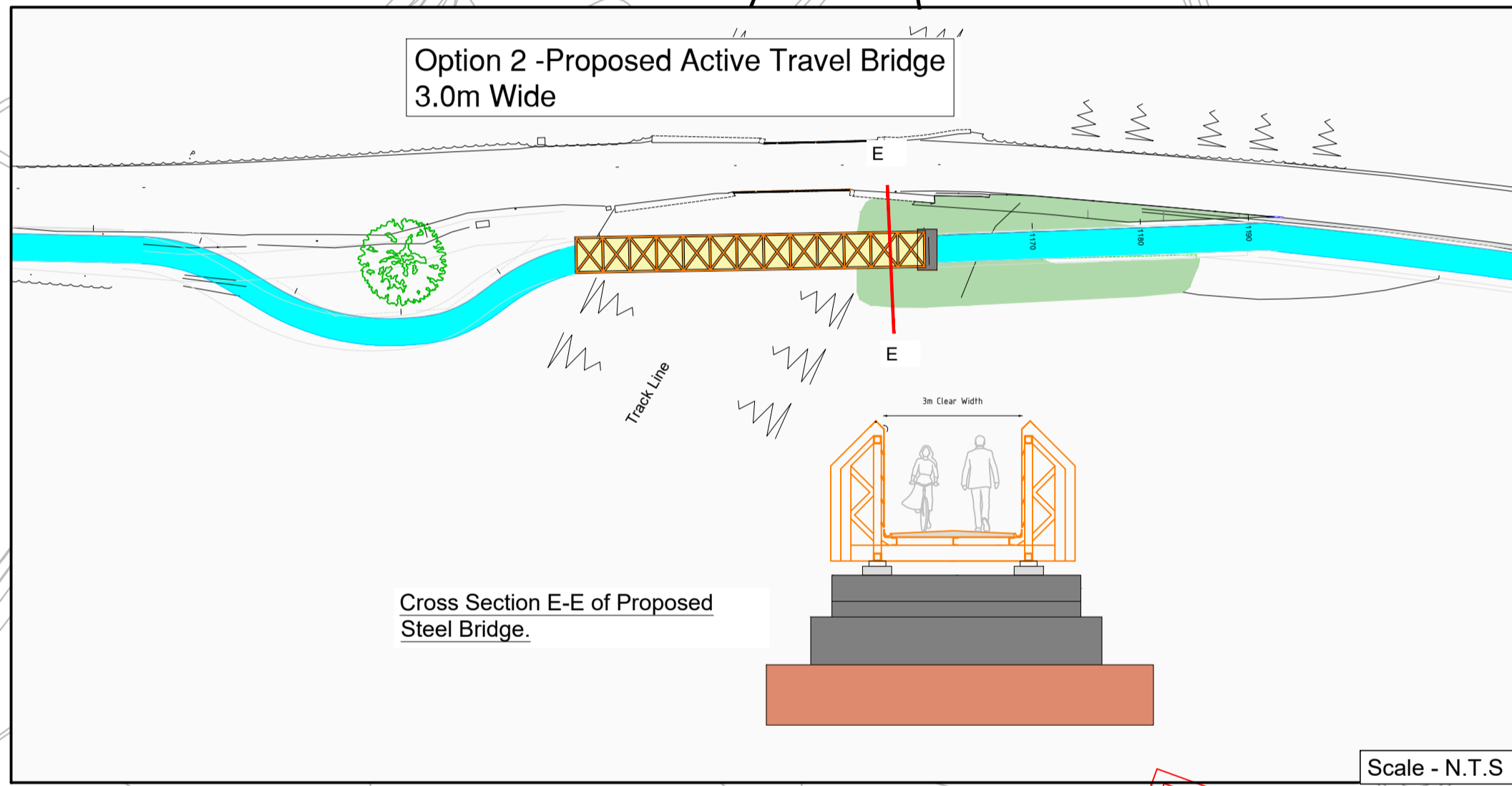

- ON ROAD CYCLING PROVISION
- WALKING PROVISION USING EXISTING FOOTWAY
- IMPROVE EXISTING FOOTWAY TO SHARED-USE PATH
- NEW SHARED-USE PATH MINIMUM 2.5M WIDE
- EXISTING PUBLIC RIGHT OF WAY
- EXISTING SHARED-USE PATH
- IMPROVE EXISTING HEDGE BANK
- NEW HEDGE BANK
- TRANSLOCATED HEDGE LINE
- AREA OF POTENTIAL ENVIRONMENTAL ENHANCEMENT

DRAFT PLAN

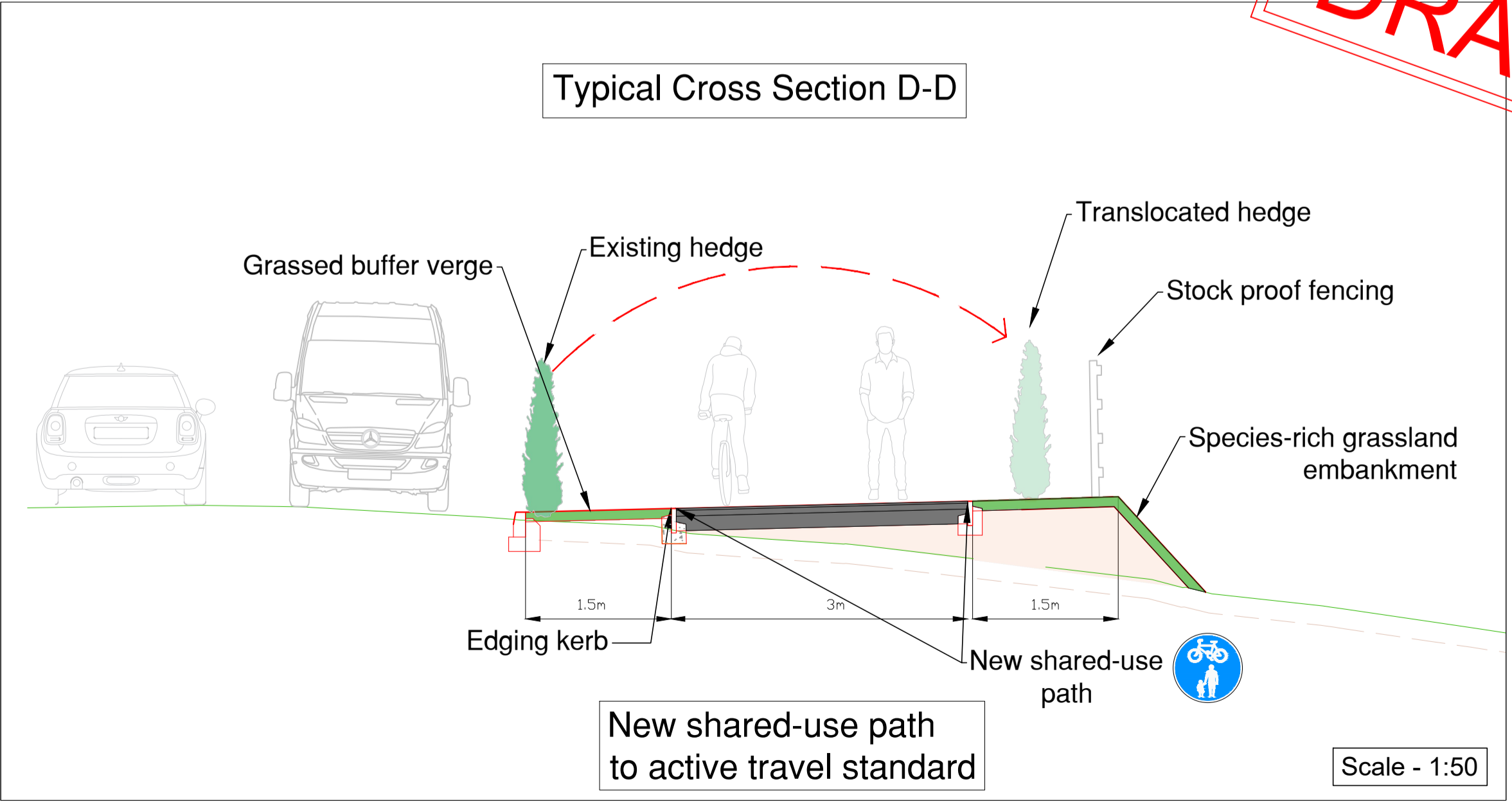
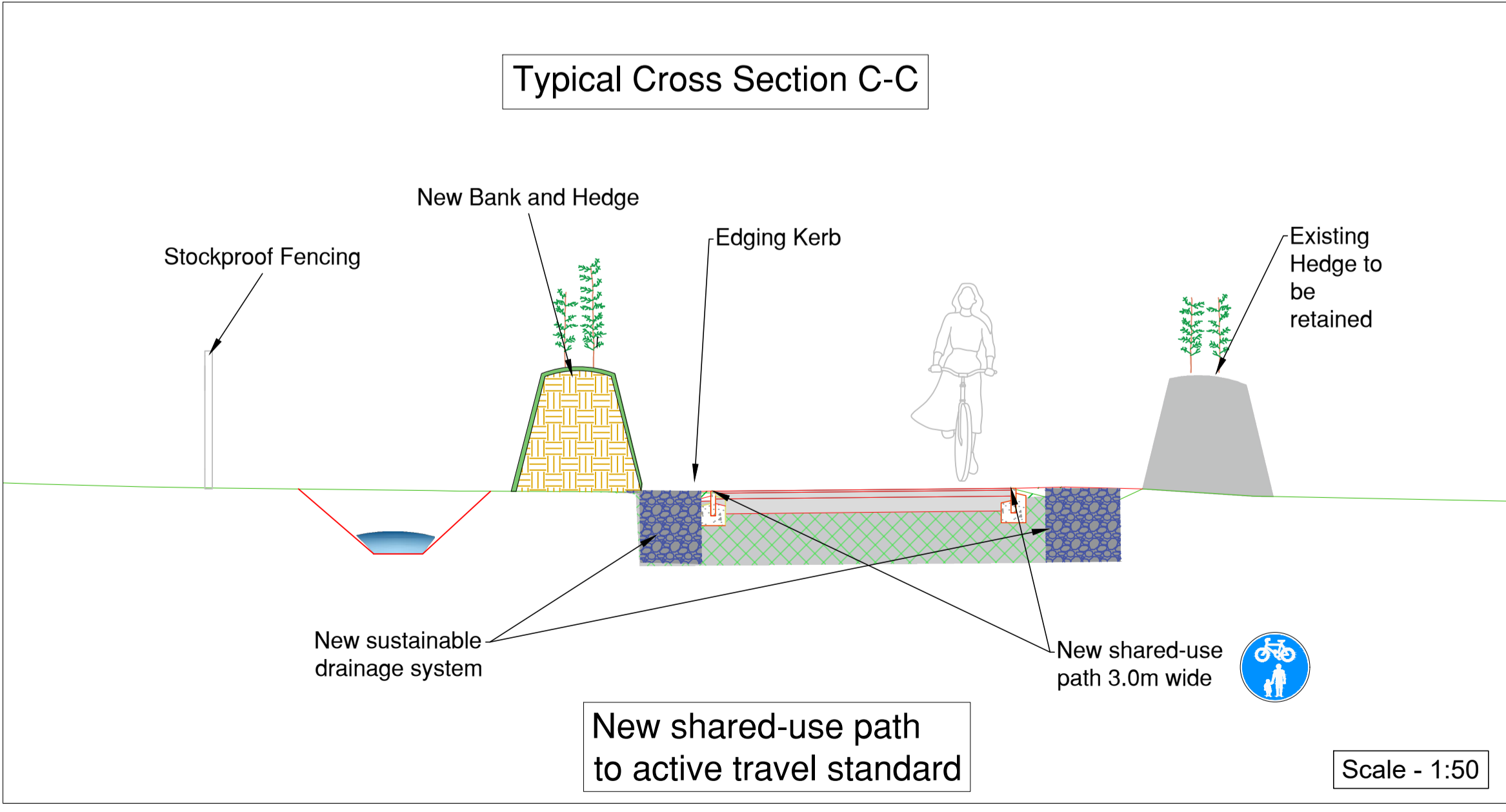

CYNLLUN / SCHEME : Waunfawr to IBERS Active Travel Link	
TEITL LLUNID / DRAWING TITLE : Stakeholder Drawing Section B	
DARLUNWYD GAN : DRAWN BY : ILT	DYDDIAD DARLUNWYD : DATE DRAWN : 30/5/23
GWIRWYD GAN : CHECKED BY : WTL	DYDDIAD GWIRWYD : DATE CHECKED : 30/5/23
Tafn Sheet 3 of 4	GRADDFEYDD : SCALES : As Shown @A1
Rhif Llunaid Drawing No. 7522/MI/101	CYWY REV