



(Cyhoeddwyd | Issued : 15/02/2023)

DEDDF DRWYDDEDU 2003 | LICENSING ACT 2003
TRWYDDED ANHEDDAU | PREMISES LICENCE

Cyngor Sir **Ceredigion** County Council

Rhif trwydded | Premises licence number: **PRM 0105 (Cyhoeddwyd | Issued : 15/02/2023)**

Rhan 1 – Manylion am y safle | Part 1 - Premises details

Cyfeiriad post y safle, neu os nad oes un, cyfeirnod map ordnans neu ddisgrifiad:
Postal address of premises, or if none, ordnance survey map reference or description:

THE MILL INN
MILL STREET

Tref bost | Post town

ABERYSTWYTH

Côd Post | Post cod

SY23 1HZ

Rhif ffôn | Telephone number

01970 612 306

Os oes cyfyngiad ar yr amser, y dyddiadau | Where the licence is time limited the dates
NID OES CYFYNGIADAU AMSER AR Y DRWYDDED
PREMISES LICENCE IS NOT TIME LIMITED

Gweithgareddau trwyddedadwy a ganiateir gan y drwydded:
Licensable activities authorised by the licence:

ADLONIAENT | REGULATED ENTERTAINMENT

FFILMIAU / FILMS

CHWARAEON DAN DO / INDOOR SPORTING EVENTS

CERDDORIAETH FYW | LIVE MUSIC

CERDDORIAETH WEDI'U RECORDIO | RECORDED MUSIC

ADWERTHU ALCOHOL | SALE BY RETAIL OF ALCOHOL

Yr amseroedd y mae'r drwydded yn caniatáu cynnal gweithgareddau trwyddedadwy
The times the licence authorises the carrying out of licensable activities

HOLL WEITHGAREDDAU / ALL ACTIVITIES

ADLONIAENT | REGULATED ENTERTAINMENT

FFILMIAU / FILMS

CHWARAEON DAN DO / INDOOR SPORTING EVENTS

CERDDORIAETH FYW | LIVE MUSIC

CERDDORIAETH WEDI'U RECORDIO | RECORDED MUSIC

ADWERTHU ALCOHOL | SALE BY RETAIL OF ALCOHOL

SUL-IAU / SUN-THURS: 11:00 – 00:00

GWE-SAD / FRI-SAT: 11:00 – 01:00

Oriau agor y safle | The opening hours of the premises

LLUN-GWE / MON-FRI: 11:00 – 00:30

SAD-SUL / SAT-SUN: 11:00 – 01:30

AMSERAU ANSAFONOL | NON-STANDARD TIMINGS:

Rydym yn gwneud cais i agor am 1100 ar 31 Rhagfyr ac yn cau ar 2 Ionawr 0000 Rydym yn gwneud cais ar gyfer achlysuron chwaraeon nad ydynt yn dod o fewn oriau agor safonol i agor awr cyn dechrau'r digwyddiad a chau awr ar ôl diwedd y digwyddiad. Bydd hyn ond yn berthnasol i dimau neu gystadleuwyr Prydeinig ac Gwyddelig sy'n cystadlu yn: Cwpan Peldroed y Byd, cpwan rygbi'r byd a theithiau, cwpan criced y byd a theithiau a'r gemau Olympaidd /We are applying to open at 1100 on the 31st December and closing on 2nd January 0000. We are applying in the event of sporting occasions that do not fall within standard opening hours to open one hour prior to the start of the event and close one hour after the conclusion of the event. This will only apply to British and Irish teams or competitors competing in: Football World cup, rugby world cup and tours, cricket world cup and tours and the Olympic games

Os yw'r drwydded yn caniatáu cyflenwi alcohol, a yw hyn yn golygu ar gyfer yfed ar y safle neu oddi yno

Where the licence authorises supplies of alcohol whether these are on and/ or off supplies

AR AC ODDI AR Y SAFLE | ON AND OFF SALES

Enw, cyfeiriad (cofrestredig), rhif ffôn ac e-bost (os yw'n berthnasol) deilydd y drwydded safle | Name, (registered) address, telephone number and email (where relevant) of holder of premises licence

CHRISTIAN BRIAN MORRIS

Rhif cofrestredig y deilydd, er enghraifft rhif cwmni, rhif elusen (os yw'n berthnasol) Registered number of holder, for example company number, charity number (where applicable)

Enw, cyfeiriad a rhif ffôn Goruchwyliwr Safle dynodedig os yw'r drwydded safle yn caniatáu cyflenwi alcohol | Name, address and telephone number of designated premises supervisor where the premises licence authorises the supply of alcohol

CHRISTIAN BRIAN MORRIS

Rhif trwydded bersonol ac enw'r awdurdod sy'n rhoi'r drwydded bersonol a ddelir gan y Goruchwyliwr Safle dynodedig os yw'r drwydded safle yn caniatáu cyflenwi alcohol Personal licence number and issuing authority of personal licence held by designated premises supervisor where the premises licence authorises for the supply of alcohol

CER 1573

CYNGOR SIR CEREDIGION / COUNTY COUNCIL

ATODIAD 1 - AMODAU GORFODOL

1 Amodau gorfodol pan fydd trwydded yn awdurdodi cyflenwi alcohol

- (1) Pan fydd trwydded safle'n awdurdodi cyflenwi alcohol, rhaid i'r drwydded gynnwys yr amodau canlynol.
- (2) Yr amod cyntaf yw na ellir cyflenwi alcohol dan y drwydded safle-
 - (a) ar adeg pan nad oes yna oruchwyliwr safle dynodedig yn unol â'r drwydded safle, neu
 - (b) ar adeg pan nad oes gan y goruchwyliwr safle dynodedig drwydded bersonol neu pan fydd ei drwydded bersonol wedi'i hatal.
- (3) Yr ail amod yw bod unrhyw alcohol a gyflenwir dan y drwydded safle'n gorfod cael ei gyflenwi neu'i awdurdodi gan berson sydd â thrwydded bersonol.

2 Amod gorfodol: dangos ffilmiau

- (1) Pan fydd trwydded safle'n awdurdodi dangos ffilmiau, rhaid i'r drwydded gynnwys amod bod mynediad i blant pan fydd unrhyw ffilm yn cael ei dangos yn cael ei gyfyngu yn unol â'r adran hon.
- (2) Pan fydd y corff categoreiddio ffilmiau'n cael ei nodi yn y drwydded, oni bai bod is-adran (3)(b) yn berthnasol, rhaid cyfyngu mynediad i blant yn unol ag unrhyw argymhelliad a wneir gan y corff hwnnw.
- (3)
 - (a) pan nad yw'r corff categoreiddio ffilmiau wedi'i nodi yn y drwydded, neu
 - (b) pan fydd yr awdurdod trwyddedu wedi hysbysu deiliad y drwydded bod yr is-adran hon yn berthnasol i'r ffilm dan sylw, dylid cyfyngu mynediad i blant yn unol ag unrhyw argymhelliad a wneir gan yr awdurdod trwyddedu hwnnw.
- (4) Yn yr adran hon -
Mae "plant" yn golygu pobl dan 18 oed; ac mae "corff categoreiddio ffilmiau" yn golygu'r person neu'r personau a ddynodwyd fel yr awdurdod dan adran 4 o Ddeddf Recordiadau Fideo 1984 (c.39) (yr awdurdod sy'n pennu addasrwydd ffilmiau fideo ar gyfer categoreiddio).

3 Amod gorfodol: goruchwyllo drysau

- (1) Pan fydd trwydded safle'n cynnwys amod bod yn rhaid i un berson neu ragor fod ar yr eiddo ar adegau penodol i gwblhau gweithgaredd diogelwch, rhaid i'r drwydded gynnwys amod bod yn rhaid i unrhyw berson o'r fath feddu ar drwydded Awdurdod y Diwydiant Diogelwch.
- (2) Ond does dim byd yn is-adran (1) sy'n gofyn am osod amod o'r fath -
 - (a) ar gyfer safleoedd o fewn paragraff 8(3)(a) o Atodlen 2 Deddf y Diwydiant Diogelwch Preifat 2001 (c.12) (safleoedd gyda thrwyddedau safle sy'n awdurdodi dramâu neu ffilmiau, neu
 - (b) ar gyfer safleoedd mewn perthynas ag-
 - (i) unrhyw achlysur a grybwyllir ym mharagraff 8(3)(b) neu (c) o'r Atodlen honno (safleoedd sy'n cael eu defnyddio gan glwb sydd â thystysgrif safle clwb yn unig, dan hysbysiad digwyddiad dros dro sy'n awdurdodi dramâu neu ffilmiau, neu dan drwydded hapchwarae, neu
 - (ii) unrhyw achlysur o fewn paragraff 8(3)(d) o'r Atodlen honno (achlysuron a bennir gan reoliadau dan y Ddeddf honno).
- (3) At ddibenion yr adran hon -
 - (a) mae "gweithgaredd diogelwch" yn golygu gweithgaredd y mae paragraff 2(1)(a) o'r Atodlen honno'n berthnasol ar ei gyfer, a
 - (b) bod paragraff 8(5) o'r Atodlen honno (dehongli cyfeiriadau at achlysur) yn berthnasol, am ei fod yn berthnasol mewn perthynas â pharagraff 8 o'r Atodlen honno.

Gorchymyn Deddf Trwyddedu 2003 (Amodau Trwyddedu Gorfodol) 2014

Yn effeithiol o 6 Ebrill 2014

1. Rhaid i berson perthnasol sicrhau na chaiff unrhyw alcohol ei werthu na'i gyflenwi i'w yfed ar y safle nac oddi arno am bris sy'n llai na'r pris a ganiateir.
2. At ddibenion yr amod a nodir ym mharagraff 1-
 - (a) mae "treth" i'w dehongli yn unol â Deddf Trethi ar Ddiodydd Alcoholaidd 1979(6);
 - (b) "y pris a ganiateir" yw'r pris a geir drwy ddefnyddio'r fformiwla –
$$P = D + (D \times V)$$
pan mai –
 - (i) P yw'r pris a ganiateir
 - (ii) D yw cyfradd y dreth sy'n daladwy mewn perthynas â'r alcohol fel pe bai'r dreth yn cael ei chodi ar ddyddiad gwerthu neu gyflenwi'r alcohol, a
 - (iii) V yw cyfradd y dreth ar werth sy'n daladwy mewn perthynas â'r alcohol fel pe bai'r dreth ar werth yn cael ei chodi ar ddyddiad gwerthu neu gyflenwi'r alcohol
 - (c) ystyr "person perthnasol", mewn perthynas â safle lle y mae trwydded safle mewn grym, yw
 - (i) Deiliad y drwydded safle,
 - (ii) Goruchwylydd dynodedig y safle (os oes un) mewn perthynas â thrwydded o'r fath, neu
 - (iii) Deiliad trwydded bersonol sy'n cyflenwi alcohol o dan drwydded o'r fath neu sy'n caniatáu iddo gael ei gyflenwi;
 - (d) ystyr "person perthnasol", mewn perthynas â safle lle y mae tystysgrif safle clwb mewn grym, yw unrhyw un o aelodau neu swyddogion y clwb sy'n bresennol ar y safle mewn rôl sy'n galluogi'r aelod neu'r swyddog i atal y cyflenwad o dan sylw; ac
 - (e) ystyr "treth ar werth" yw treth ar werth sy'n daladwy yn unol â Deddf Treth ar Werth 1994(7)
3. Os nad yw'r pris a ganiateir a roddir gan Baragraff (b) o baragraff 2 (ar wahân i'r paragraff hwn) yn rhif cyfan o geiniogau, rhaid cymryd mai'r pris a roddir gan yr is-baragraff hwnnw yw'r pris a roddir mewn gwirionedd gan yr is-baragraff hwnnw wedi'i dalgrynnu i fyny i'r geiniog agosaf.
4. (1) Mae is-baragraff (2) yn gymwys os yw'r pris a ganiateir gan Baragraff (b) o baragraff 2 ar y naill ddiwrnod ("y diwrnod cyntaf") yn wahanol i'r pris a ganiateir ar y diwrnod nesaf ("yr ail ddiwrnod") o ganlyniad i newid i gyfradd y dreth neu'r dreth ar werth.

(2) Mae'r pris a ganiateir sy'n gymwys ar y diwrnod cyntaf yn gymwys i werthiant neu gyflenwad alcohol sy'n digwydd cyn i'r cyfnod o 14 diwrnod sy'n dechrau ar yr ail ddiwrnod ddod i ben.

Gorchymyn Deddf Trwyddedu 2003 (Amodau Trwyddedu Gorfodol) (Diwygio) 2014

Mae'r Amodau Gorfodol isod yn **disodli** Gorchymyn Deddf Trwyddedu 2003 (Amodau Trwyddedu Gorfodol) 2010 a daethant i rym ar **1 Hydref 2014**.

Mae amodau 1 i 4 yn cyfeirio at yr holl safleoedd sy'n gwerthu neu gyflenwi alcohol i'w yfed ar y safle. Mae amod 3 yn berthnasol i safleoedd sy'n gwerthu alcohol i'w yfed oddi ar y safle.

1. (1) Rhaid i'r person cyfrifol sicrhau nad yw staff ar y safle perthnasol yn ymgymryd â, yn trefnu neu'n cymryd rhan mewn unrhyw hyrwyddo anghyfrifol mewn perthynas â'r safle.

(2) Yn y paragraff hwn, mae hyrwyddo anghyfrifol yn golygu un neu fwy o'r gweithgareddau a ganlyn, neu weithgareddau sy'n sylweddol debyg, sy'n digwydd er mwyn hyrwyddo gwerthiant neu gyflenwad o alcohol i'w yfed ar y safle -

(a) gemau neu weithgareddau eraill sy'n gofyn am neu'n hybu, neu sydd wedi'u dylunio i ofyn neu i hybu unigolion i -

(i) yfed swm o alcohol o fewn cyfyngiad amser (heblaw yfed alcohol a werthwyd neu a gyflenwyd ar y safle cyn terfyn y cyfnod y mae'r unigolyn cyfrifol wedi'i awdurdodi i werthu neu gyflenwi alcohol), neu

(ii) yfed cymaint o alcohol â phosib (un ai mewn cyfyngiad amser neu fel arall);

(b) darparu swm diddiwedd neu amhenodol o alcohol am ddim neu am bris penodedig neu ar ddisgownt i'r cyhoedd neu i grŵp a gaiff ei ddiffinio gan nodwedd benodol sy'n peri risg sylweddol o danseilio amcan trwyddedu;

(c) darparu alcohol am ddim neu ar ddisgownt neu unrhyw beth arall fel gwobr i annog neu i wobrwyo prynu ac yfed alcohol dros gyfnod o 24 awr neu lai mewn modd sy'n peri risg sylweddol o danseilio amcan trwyddedu;

(d) gwerthu neu gyflenwi alcohol mewn cysylltiad â phosteri neu bamffledi ar, neu yng nghyffiniau'r safle, a ellir ei ystyried yn rhesymol fel ei fod yn caniatáu, neu'n annog neu'n cyfeirio at effeithiau meddwdod ac ymddygiad gwrthgymdeithasol mewn modd ffafriol;

(e) unigolyn yn tywallt alcohol yn uniongyrchol i geg unigolyn arall (heblaw pan fo unigolyn yn methu yfed heb gymorth oherwydd anabledd).

2. Rhaid i'r unigolyn cyfrifol sicrhau fod dŵr yfed am ddim yn cael ei ddarparu ar gais i gwsmeriaid pan fod hyn ar gael yn rhesymol.

3. (1) Rhaid i ddeilydd y drwydded eiddo neu ddeilydd y dystysgrif eiddo clwb sicrhau y gweithredir polisi gwirio oed ar y safle mewn perthynas â gwerthu neu gyflenwi alcohol.

(2) Rhaid i oruchwyliwr dynodedig y safle mewn perthynas â'r drwydded eiddo sicrhau bod gwerthiant alcohol ar y safle yn digwydd yn unol â'r polisi gwirio oed.

(3) Rhaid i'r polisi fynnu bod unigolion sy'n edrych dan 18 oed i'r person cyfrifol (neu'r oed hŷn a nodir yn y polisi) ddangos ar gais, cyn cael prynu alcohol, tystiolaeth yn cynnwys eu llun, dyddiad geni a naill ai -

(a) marc holograffig, neu

(b) nodwedd uwchfioled.

4. Rhaid i'r unigolyn cyfrifol sicrhau -

(a) os caiff unrhyw un o'r diodydd alcoholig canlynol eu gwerthu neu eu cyflenwi i'w hyfed ar y safle (heblaw am ddiodydd alcohol sy'n cael eu gwerthu neu eu cyflenwi ar ôl eu gwneud yn barod i'w gwerthu mewn cynhwysydd wedi'i gau'n ddiogel), bydd yr alcohol ar werth i gwsmeriaid yn y mesurau a ganlyn -

(i) cwrw neu seidr: ½ pint;

(ii) jin, rym, fodca neu wisgi: 25 ml neu 35 ml; a

(iii) gwin llonydd mewn gwydryn: 125 ml;

(b) caiff y mesurau hyn eu dangos mewn bwydlen, ar restr brisiau neu ddeunydd printiedig arall sydd ar gael i gwsmeriaid ar y safle; a

(c) lle nad yw cwsmer, mewn perthynas â gwerthiant alcohol, yn manylu ar y swm o alcohol i'w werthu, bydd y gwerthwr yn hysbysu'r cwsmer fod y mesurau hyn ar gael.

Annex 1 - MANDATORY CONDITIONS

1 Mandatory conditions where licence authorises supply of alcohol

- (1) Where a premises licence authorises the supply of alcohol, the licence must include the following conditions.
- (2) The first condition is that no supply of alcohol may be made under the premises licence-
 - (a) at a time when there is no designated premises supervisor in respect of the premises licence, or
 - (b) at a time when the designated premises supervisor does not hold a personal licence or his personal licence is suspended.
- (3) The second condition is that every supply of alcohol under the premises licence must be made or authorised by a person who holds a personal licence.

2 Mandatory condition: exhibition of films

- (1) Where a premises licence authorises the exhibition of films, the licence must include a condition requiring the admission of children to the exhibition of any film to be restricted in accordance with this section.
- (2) Where the film classification body is specified in the licence, unless subsection (3)(b) applies, admission of children must be restricted in accordance with any recommendation made by that body.
- (3) Where-
 - (a) the film classification body is not specified in the licence, or
 - (b) the relevant licensing authority has notified the holder of the licence that this subsection applies to the film in question, admission of children must be restricted in accordance with any recommendation made by that licensing authority.
- (4) In this section - "children" means persons aged under 18; and "film classification body" means the person or persons designated as the authority under section 4 of the Video Recordings Act 1984 (c.39) (authority to determine suitability of video works for classification).

3 Mandatory condition: door supervision

- (1) Where a premises licence includes a condition that at specified times one or more individuals must be at the premises to carry out a security activity, the licence must include a condition that each such individual must be licensed by the Security Industry Authority.
- (2) But nothing in subsection (1) requires such a condition to be imposed-
 - (a) in respect of premises within paragraph 8(3)(a) of Schedule 2 to the Private Security Industry Act 2001 (c.12) (premises with premises licenses authorising plays or films), or
 - (b) in respect of premises in relation to-
 - (i) any occasion mentioned in paragraph 8(3)(b) or (c) of that Schedule (premises being used exclusively by club with club premises certificate, under a temporary event notice authorising plays or films or under a gaming licence), or
 - (ii) any occasion within paragraph 8(3)(d) of that Schedule (occasions prescribed by regulations under that Act).
- (3) For the purposes of this section-

- (a) "security activity" means an activity to which paragraph 2(1)(a) of that Schedule applies, and
- (b) paragraph 8(5) of that Schedule (interpretation of references to an occasion) applies as it applies in relation to paragraph 8 of that Schedule.

The Licensing Act 2003 (Mandatory Licensing Conditions) Order 2014

With effect from 28th May 2014

1. A relevant person shall ensure that no alcohol is sold or supplied for consumption on or off the premises for a price which is less than the permitted price.
2. For the purposes of the condition set out in paragraph 1-
 - (a) "duty" is to be construed in accordance with the Alcoholic Liquor Duties Act 1979;
 - (b) "permitted price" is the price found by applying the formula –
$$P = D + (D \times V)$$
where –
 - (i) P is the permitted price
 - (ii) D is the rate of duty chargeable in relation to the alcohol as if the duty were charged on the date of the sale or supply of the alcohol, and
 - (iii) V is the rate of value added tax chargeable in relation to the alcohol as if the value added tax were charged on the date of the sale or supply of the alcohol
 - (c) "relevant person" means, in relation to premises in respect of which there is in force a premises licence –
 - (i) The holder of the premises licence,
 - (ii) The designated premises supervisor (if any) in respect of such a licence, or
 - (iii) The personal licence holder who makes or authorises a supply of alcohol under such a licence;
 - (d) "relevant person" means, in relation to premises in respect of which there is in force a club premises certificate, any member or officer of the club present on the premises in a capacity which enables the member or officer to prevent the supply in question; and
 - (e) "valued added tax" means value added tax charged in accordance with the Value Added Tax Act 1994
3. Where the permitted price given by Paragraph (b) of paragraph 2 would (apart from this paragraph) not be a whole number of pennies, the price given by that sub-paragraph shall be taken to be the price actually given by that sub-paragraph rounded up to the nearest penny.

4. (1) Sub-paragraph (2) applies where the permitted price by Paragraph (b) of paragraph 2 on a day (“the first day”) would be different from the permitted price on the next day (“the second day”) as a result of a change to the rate of duty or value added tax.

(2) The permitted price which would apply on the first day applies to sales or supplies of alcohol which take place before the expiry of the period of 14 days beginning on the second day.

The Licensing Act 2003 (Mandatory Licensing Conditions) (Amendment) Order 2014

The below Mandatory Conditions **replace** the Licensing Act 2003 (Mandatory Licensing Conditions) Order 2010 and comes into effect **on 1st October 2014**

Conditions 1 to 4 refer to all premises that sell or supply alcohol for consumption on the premises. Condition 3 is relevant to Premises that sell for consumption off the premises.

1. (1) The responsible person must ensure that staff on relevant premises do not carry out, arrange or participate in any irresponsible promotions in relation to the premises.

(2) In this paragraph, an irresponsible promotion means any one or more of the following activities, or substantially similar activities, carried on for the purpose of encouraging the sale or supply of alcohol for consumption on the premises—

(a) games or other activities which require or encourage, or are designed to require or encourage, individuals to—

(i) drink a quantity of alcohol within a time limit (other than to drink alcohol sold or supplied on the premises before the cessation of the period in which the responsible person is authorised to sell or supply alcohol), or

(ii) drink as much alcohol as possible (whether within a time limit or otherwise);

(b) provision of unlimited or unspecified quantities of alcohol free or for a fixed or discounted fee to the public or to a group defined by a particular characteristic in a manner which carries a significant risk of undermining a licensing objective;

(c) provision of free or discounted alcohol or any other thing as a prize to encourage or reward the purchase and consumption of alcohol over a period of 24 hours or less in a manner which carries a significant risk of undermining a licensing objective;

(d) selling or supplying alcohol in association with promotional posters or flyers on, or in the vicinity of, the premises which can reasonably be considered to condone, encourage or glamorise anti-social behaviour or to refer to the effects of drunkenness in any favourable manner;

(e) dispensing alcohol directly by one person into the mouth of another (other than where that other person is unable to drink without assistance by reason of disability).

2. The responsible person must ensure that free potable water is provided on request to customers where it is reasonably available.

3. (1) The premises licence holder or club premises certificate holder must ensure that an age verification policy is adopted in respect of the premises in relation to the sale or supply of alcohol.

(2) The designated premises supervisor in relation to the premises licence must ensure that the supply of alcohol at the premises is carried on in accordance with the age verification policy.

(3) The policy must require individuals who appear to the responsible person to be under 18 years of age (or such older age as may be specified in the policy) to produce on request, before being served alcohol, identification bearing their photograph, date of birth and either—

- (a) a holographic mark, or
- (b) an ultraviolet feature.

4. The responsible person must ensure that—

(a) where any of the following alcoholic drinks is sold or supplied for consumption on the premises (other than alcoholic drinks sold or supplied having been made up in advance ready for sale or supply in a securely closed container) it is available to customers in the following measures—

- (i) beer or cider: ½ pint;
- (ii) gin, rum, vodka or whisky: 25 ml or 35 ml; and
- (iii) still wine in a glass: 125 ml;

(b) these measures are displayed in a menu, price list or other printed material which is available to customers on the premises; and

(c) where a customer does not in relation to a sale of alcohol specify the quantity of alcohol to be sold, the customer is made aware that these measures are available.”

Atodiad 2 – Amodau sy'n gyson â'r Rhestr weithredu

Cyffredinol – pob un o'r pedwar amcan trwyddedu

- Bydd polisïau'r cwmni'n cael eu rhannu gyda phob aelod o staff.
- Bydd rhoi 30 munud i'r cwsmeriaid orffen eu diodydd yn golygu bod cwsmeriaid yn gwasgaru mewn modd addas, ac yn rhoi cyfle iddynt ddefnyddio'r tai bach yn ystod amser cau'r safle.
- Bydd hyfforddiant staff yn cael ei gofnodi. Bydd y staff yn derbyn hyfforddiant ynghylch iechyd a diogelwch, adrodd am ddamweiniau, adrodd am ddigwyddiadau, glanhau, diogelwch tân a pholisïau'r cwmni.

b) Atal trosedd ac anhrefn

- Mae'r safle wedi tanysgrifio i'r Gymdeithas Tafarnwyr Trwyddedig (LVA) ac yn cefnogi'r gymdeithas honno'n frwd.
- Mynd i gyfarfodydd yr awdurdod heddlu lleol.
- Aelod o Gynllun Pub Watch Aberystwyth – Fel rhan o'r cynllun mae'r safle'n gobeithio derbyn a darparu gwybodaeth ynghylch pobl sy'n ymddwyn yn anghyfrifol, anghyfreithlon a / neu'n wrthgymdeithasol, ac felly bydd yn gallu cymryd camau i wrthod darparu gwasanaeth ac os bydd angen bydd yn gwahardd y bobl o'r safle ac yn rhoi gwybod i'r heddlu.
- Hyfforddiant i'r staff am bolisïau'r cwmni ynghylch y safonau sy'n dderbyniol o ran ymddygiad cwsmeriaid.
- Adrodd i'r awdurdodau perthnasol a thrwyddedai eraill ynghyd â rhannu gwybodaeth â hwy.
- Gweithredu polisïau'r cwmni (Atodiad A isod) a chanllawiau'r awdurdod heddlu lleol ynghylch cyflenwi alcohol i'r cyhoedd. Mae'r staff yn ymwybodol o'r angen i werthu alcohol mewn modd cyfrifol, a'r goblygiadau os na wneir hynny.
- Ni fyddwn yn marchnata unrhyw gynigion arbennig er mwyn hyrwyddo yfed yn synhwyrol.
- Bydd y safle'n arddangos deunydd gan awdurdod Heddlu Dyfed Powys ynghylch Bihafiwch neu Cewch Eich Banio, Diodydd wedi'u Sbeicio, Yfed o dan Oed, Yfed a Gyrru a phob menter arall sydd i ddod.
- Gweithredu ymgyrchoedd cenedlaethol megis RSOD – a oedd yn ceisio codi ymwybyddiaeth am beryglon posib goryfed mewn pyliau.

c) Diogelwch y cyhoedd

- Diogelwch tân - mae gennym ddau ddiffoddwr tân addas ar y safle yn unol â chyngor y cwmni arbenigol K&D Fire Protection. Caiff y rhain eu harchwilio bob blwyddyn.
- Cymorth cyntaf – mae digon o gyfarpar cymorth cyntaf ar gael ar y safle. Cofnodir pob damwain mewn llyfr log.
- Ni oddefir unrhyw ymddygiad gwrthgymdeithasol o gwbl, a bydd hyn yn cynnwys gwrthod pobl sy'n feddw, yn swnllyd, yn gecrus, naill ai oherwydd alcohol neu gyffuriau, pobl sydd o dan oed neu bobl sy'n ceisio prynu diodydd ar gyfer rhywun sydd o dan oed.
- Caiff unrhyw wydrau sydd wedi torri eu clirio'n syth er mwyn osgoi niwed i gwsmeriaid a staff.
- Atal cwsmeriaid rhag cario gwydrau a photeli agored ar y stryd, er mwyn cydymffurfio â menter yr heddlu lleol sy'n rhwystro yfed mewn mannau cyhoeddus. Mae hyn hefyd yn atal niwsans i'r cymdogion ac yn atal sbwriel rhag cael ei adael ar hyd y lle.
- Caiff posteri eu harddangos i rybuddio cwsmeriaid ynghylch gadael diodydd heb gadw llygad arnynt a'r posibilrwydd y bydd diodydd yn cael eu sbeicio.
- Hyfforddir staff er mwyn sicrhau nad ydy cwsmeriaid sy'n agored i niwed yn cael eu herlid na'u targedu gan gwsmeriaid eraill.

d) Atal niwsans cyhoeddus

- Gwnaed cais am yr oriau dan sylw er mwyn hyrwyddo'r amcan hwn, drwy gau ar amser rhesymol mewn ardal breswyl.
- Bydd y trwyddedai yn mynd ati'n frwd i annog perthnasau da â'r preswylwyr lleol, awdurdod yr heddlu a swyddogion y cyngor lleol. Bydd hyn yn cynnwys mynd i gyfarfodydd cyhoeddus ynghylch yr ardal leol ac annog preswylwyr i godi unrhyw bryderon posib, er mwyn gallu osgoi sefyllfaoedd. Yn ogystal, ein nod yw bod yn aelod gwerthfawr a chyfrifol o'r gymuned leol.
- Bydd cerddoriaeth fyw a cherddoriaeth a recordiwyd yn gorffen pan fydd y safle'n stopio gwerthu alcohol. Yn ogystal, bydd y lefelau sŵn yn cael eu monitro'n gyson.
- Byddwn yn sicrhau bod sbwriel yn cael ei leoli mewn un man, yn cael ei roi mewn bagiau priodol yn barod i'w gasglu ac ni fyddwn yn gadael sbwriel ar hyd y lle.
- Atal cwsmeriaid rhag cario gwydrau a photeli agored ar y stryd, er mwyn cydymffurfio â menter yr heddlu lleol sy'n rhwystro yfed mewn mannau cyhoeddus. Mae hyn hefyd yn atal niwsans i'r cymdogion ac yn atal sbwriel rhag cael ei adael ar hyd y lle.
- Pan fo angen, bydd staff yn trefnu tacsis i gludo cwsmeriaid o'r safle.
- Bydd Goruchwyliwr Penodedig y Safle yn sefyll o fewn 50 llath i'r adeilad er mwyn sicrhau bod y lefelau sŵn yn dderbyniol adeg cau'r safle.

e) Amddiffyn plant rhag niwed

- Mae pob aelod o staff wedi cael eu hyfforddi i ofyn am brawf o oedran os ydynt yn amau bod rhywun o dan oed. Mae gan bob aelod o staff yr hawl i wrthod darparu gwasanaeth i rywun.
- Bydd y safle'n arddangos canllawiau'r awdurdod heddlu lleol ynghylch yr ymddygiad a ddisgwylir gan gwsmeriaid.
- Caniateir plant rhwng 14 ac 18 oed ar y safle os oes oedolyn gyda hwy. Bydd y staff yn sicrhau nad oes neb yn rhoi alcohol i'r plant hyn ac os bydd oedolyn yn ceisio prynu alcohol ar ran y plant bydd y staff yn gofyn iddynt adael y safle.
- Byddwn yn rhannu gwybodaeth gyda safleoedd trwyddedig eraill trwy'r Cynllun Pub Watch.
- Ni chaniateir i blant fod ar y safle pan gaiff ffilmiau eu dangos, a hynny er mwyn cydymffurfio'n llwyr â thystysgrif oed pob ffilm. (Ni fyddwn yn dangos unrhyw ffilmiau sy'n amlwg yn rhywiol ar y safle.)
- Ni chaniateir i blant chwarae'r peiriannau hapchwarae. Bydd y staff yn cael hyfforddiant ynghylch y polisi hwn, a bydd pob peiriant yn arddangos hysbysiad sy'n gwahardd chwaraewyr dan oed.

Annex 2 - Conditions consistent with the operating Schedule

General – All four licensing objectives

- Company policies to be communicated to all staff
- 30 minute 'drinking up time' will allow appropriate dispersal of customers, and the use of toilets at closing time.
- Staff training to be documented. Staff will receive training in health and safety, accident reporting, incident reporting, cleaning, fire safety and company policies.

b) Prevention of crime and disorder

- Subscription to and active support to LVA
- Attendance to local police authority meetings
- Membership to Aberystwyth Pub Watch Scheme – As part of the scheme the premises hope to provided with, and also to provide, information regarding persons who are acting irresponsibly, illegally and/or antisocially, and therefore be able to take steps to refuse service and if necessary ban persons from the premises and inform the police.
- Staff training on company policies regarding acceptable standards of behaviour for customers.
- Reporting and sharing intelligence information to the relevant authorities and other licences.
- Implementing company policies (appendix a below) and local police authority guidelines relating to supply of alcohol to the public. Staff are aware of need to ensure responsible sale of alcohol, and the implication for not doing so.
- No Happy Hour marketing to promote sensible drinking.
- Premises to display issued via Dyfed Powys Police authority relating to Behave or be Banned, Spiked Drinks, Underage Drinking, Drinking and Driving and all forthcoming initiatives.
- Implementing national campaigns such as RSOD – which aimed to raise awareness about the potential dangers of binge drinking.

c) Public safety

- Fire safety, we have two appropriate fire extinguishers on site as advised by specialist company K&D Fire Protection. These are inspected on annual basis.
- First aid, adequate first aid equipment is available on the premises. All accidents are reported in a log book
- Zero tolerance to ant social behaviour, to include refusal to those intoxicated, noisy, aggressive, either through drink or drugs, underage or those who attempt to purchase for those underage.
- Glass breakage to be cleared quickly to avoid harm to customers and staff
- Prevent customers carrying open bottles and glasses onto the street, to comply with local police initiative banning drinking in public. This also prevents nuisance to neighbors and potential littering.
- Posters are displayed to warn of the dangers of leaving drinks unattended and the possibility of drinks being spiked.
- Staff are trained to ensure vulnerable customers are not victimised or targeted by other customers.

d) Prevention of public nuisance

- The hours applied for are to promote this objective, by closing at a reasonable time in a residential area.

(Cyhoeddwyd | Issued : 15/02/2023)

- The licensee to actively encourage good relations with local residents, police authority and local council officials. This will include attending public meetings in relation to the local area and encourage residents to air any potential concerns, so that situations can be avoided, in addition it is our objective to become a valuable and responsible member of the local community.
- Live and recorded music will cease when sale of alcohol stops. In addition level of noise to be constantly monitored.
- We will ensure that refuse will be located in one area, properly bagged ready for collection, and will not litter the area.
- Prevent customers carrying open bottles and glasses onto the street, to comply with local police imitative banning drinking in public. This also prevents nuisance to neighbours and potential littering.
- When required staff will organise taxi's to transport customers off the premises.
- The Designated Premises Supervisor to stand within a 50yd area of the building to ensure that noise levels are acceptable at closing time.

e) Protection of children from harm

- All staff have been trained to request proof of age if they suspect someone is underage. All staff have the right to refuse service.
- The premises will display the local police authority guidelines on behaviour expected from customers.
- Children between the ages of 14-18 are permitted if an adult accompanies them. Staff will ensure that these children are not given alcohol and in the event of any adult attempting to purchase on their behalf they will be asked to leave the premises.
- We will share intelligence with other licensed premises trough the medium of the Pub Watch Scheme.
- Children will not be permitted during the showing of any films, so that we can fully comply with the certified age limits of each film. (We will not show sexually explicit films on the premises).
- Children will not be allowed to play on gambling machines. Staff will be trained on this policy, in addition each machine will display a notice prohibiting underage players.

Appendix A

Ship & Castle The Mill Inn

COMPANY POLICIES

1, Health and safety

You have a duty to take reasonable care for the health and safety of yourself and of other persons who may be affected by your acts or omissions. You have a duty to co-operate with the Company in complying with any statutory duty or requirement concerning health and safety at work and to draw any relevant matters to the attention of your manager.

All items listed below must be reported to the manager as soon as possible;

- Broken or faulty equipment*
- Broken or faulty furniture, fixings or fabric of the building*
- Anything that may impede the access or exit of the building*
- Broken or faulty fire fighting equipment*

*Specifically with health and safety and accident prevention in mind, the following items are to be rectified as soon as you are aware of them. (This list is not exhaustive)
Glass breakages, spillages and wet floors.*

All accidents and incidents must be recorded in the accident book which is located by the till in each premises. Remember to record as much information as possible. Every entry must be brought to the managers attention.

2, Bar Service

All alcoholic drinks must be served in approved glasses. The manager will show you the appropriate glass for each type of beverage.

You must not serve more than a double measure in one serving to a customer

Payment must be received for all beverages/snacks at the time of consumption. (Giving a customer or staff member any drinks, stock or snack items on 'tick' is strictly forbidden, and will be treated as gross misconduct resulting in dismissal)

Ship & Castle The Mill Inn

3, Cash and Till Procedures

All transactions must be made through the till.

Only cash from the UK and N Ireland can be accepted. Cheques can only be accepted in the presence of the manager. Cashing cheques is strictly forbidden. Credit cards are not accepted. The manager will train you on how to screen notes for forgeries.

4, Customer Service and Standards of Behaviour

Whilst on duty you must ensure that you are polite and professional at all times.

You have the right to refuse service when you suspect a person is ;
Intoxicated through drink or drugs

Or

Is under age. You must ask for ID/proof of a customers' age if you know or suspect a person of being underage

Or

Is causing offence through

- Aggressive or abusive behaviour
- Excess shouting, chanting or singing
- Making religious or racial statements
- Sexual discrimination
- Making comment on a persons' physical or mental capabilities
- Enticement to cause disruptive behaviour
- Committing a criminal offence

You MUST inform the premises supervisor immediately and you may need to contact the police for assistance. Remember to stay calm and try to retain as much information as possible which may be needed by the police if a statement is required.

In addition you must recall all relevant information that needs to be passed through the PubWatch Scheme.

If you fail to comply with the 'refusal to serve policies' shown above you will be dismissed, because you will be breaking the law and or the company policy.

Ship & Castle The Mill Inn

4, Customer Service and Standards of Behaviour continued

You must ensure that no unaccompanied children under the age of 14 enter the premises.
You must ensure that children between the ages of 14 – 18 are accompanied by a responsible adult, and do not consume or purchase any alcoholic beverages.
You must ensure that the gambling machines are only played by adults whom are 18 and over. If you are unsure as to their age, ask for ID. Also draw their attention to the notice displayed on each machine.

5, Allowed Hours

You must ensure that the premises is ready to open on time. Any defects to be reported to the premises supervisor or licensee immediately.
You must ensure that alcohol is not served before or after the 'allowed hours' as directed by the licence. The licensee will inform you of all 'allowed hours' if you are unsure.

6, Premises Security

You must ensure that all windows, doors and cellar hatches are properly secured at the end of the night or at the request of the premises supervisor/licensee.

7, Personal property

In the event that you should find or have returned to you an item of personal property such as a purse, mobile phone or item of clothing, you must give the item to the premises supervisor or licensee.

The company does not insure employees' property and accepts no liability for loss or damage.

8, Statutory Requirements

You are required to attend all training sessions and inform your manager should you fail to comprehend any information given.

Ship & Castle The Mill Inn

9, Outside Interests

You may not make personal profit from the company's business, nor receive any gift or benefit from any person or organisation supplying goods to or dealing with the company.

10, Confidentiality

You may not disclose figures or other information about the company or premises to anyone. In the event for a request for information you must inform the manager immediately.

Staff Details
Mill Inn - Ship & Castle

Name.....

Address.....

.....

.....

Contact telephone number.....

Date of birth.....

National insurance number.....

Next of kin details;

Relationship.....

Contact number.....

Start Date.....

Training

Subject	Date	Trainer	Signature of trainee
Company Policies			
Accident Reporting			
Health and Safety			
Cleaning			
Fire Safety			
Incident Reporting			

Confidential information to be held by I. Blair and U Daniel only, and destroyed upon departure from the afore mentioned employment.

9/7/2004

(Cyhoeddwyd | Issued : 15/02/2023)

Amodau yn atodedig yn sgil gwrandawriad gan yr awdurdod trwyddedu/cyfarfod cyfryngu

Annex 3 - Conditions attached after a hearing by the licensing authority/ Mediation meeting

Atodiad 4 – Cynlluniau | Annex 4 – Plans

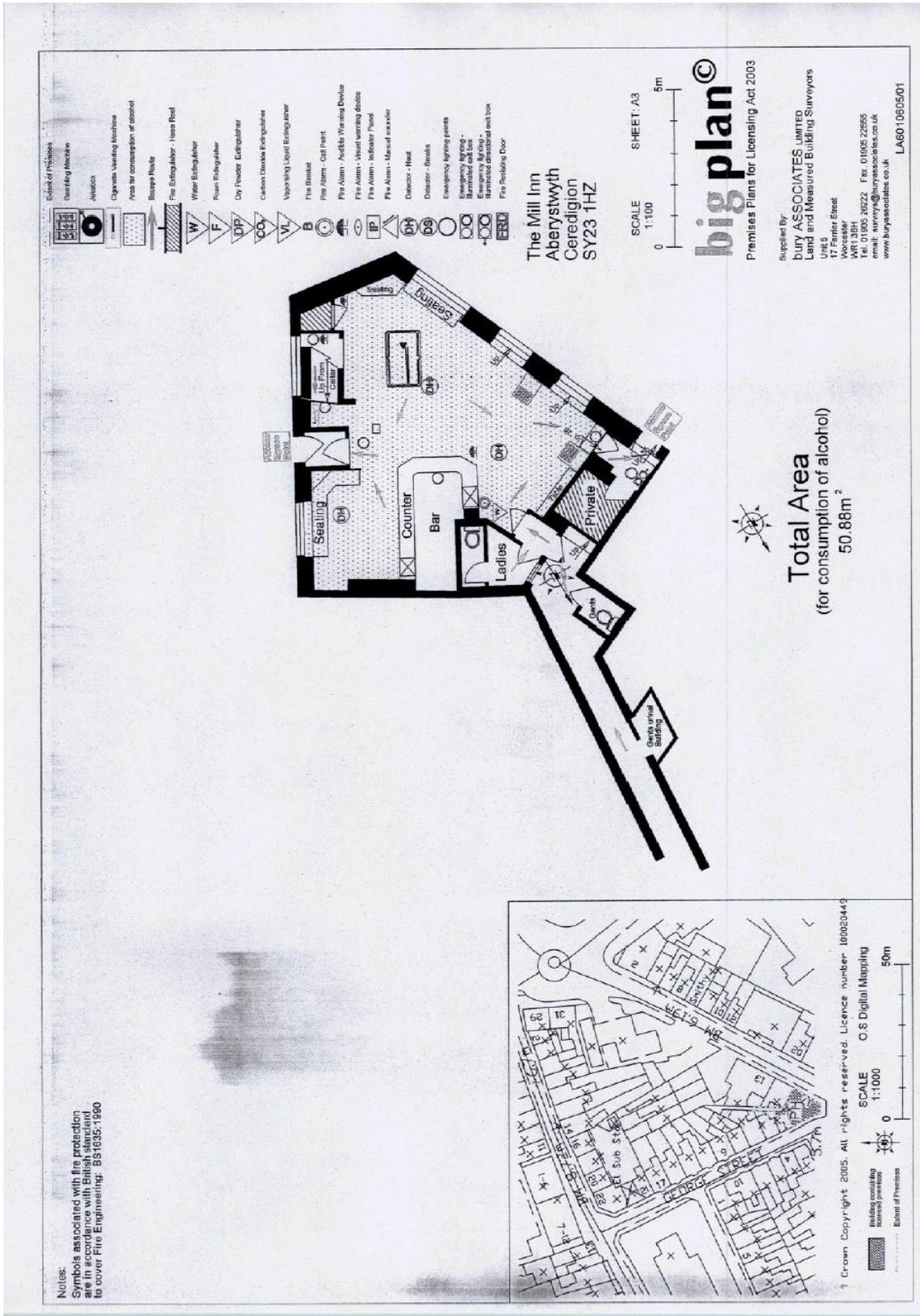

(Cyhoeddwyd | Issued : 15/02/2023)