



**LICENSING ACT 2003  
PREMISES LICENCE**

Cyngor Sir **Ceredigion** County Council



**s licence number**

**PRM 0647 (Issued 29/10/2013)**

**Premises details**

**Postal address of premises, or if none, ordnance survey map reference or description**

**MANTLE BREWERY LIMITED  
UNIT 16  
PENTOOD INDUSTRIAL ESTATE**

**Post town  
CARDIGAN**

**Post code  
SA43 3AG**

**Telephone number  
01239 623898**

**Where the licence is time limited the dates**

**LICENCE NOT TIME LIMITED**

**Licensable activities authorised by the licence**

**SALE BY RETAIL OF ALCOHOL – On and Off Sales**

**The times the licence authorises the carrying out of licensable activities**

**SALE BY RETAIL OF ALCOHOL – On and Off Sales**

**MON – SUN: 0900hrs – 2300hrs**

**The opening hours of the premises**

**MON – SUN: 0700hrs – 2330hrs**

**Where the licence authorises supplies of alcohol whether these are on and/  
or off supplies**

**OFF SALES ONLY**

**Name, (registered) address, telephone number and email (where relevant) of holder of premises licence**

**MANTLE BREWERY LIMITED**

**UNIT 16  
PENTOOD INDUSTRIAL ESTATE  
CARDIGAN  
CEREDIGION  
SA43 3AG**

**Tel: 01239 623898**

**E-mail: info@mantlebrewery.com**

**Registered number of holder, for example company number, charity number (where applicable)**

**7693203 – Limited Company**

**Name, address and telephone number of designated premises supervisor where the premises licence authorises the supply of alcohol**

**IAN KIMBER**

**Personal licence number and issuing authority of personal licence held by designated premises supervisor where the premises licence authorises for the supply of alcohol**

**PERS/N/1222**

**PEMBROKESHIRE COUNTY COUNCIL**

## **Annex 1 - Mandatory conditions**

### **Mandatory conditions where licence authorises supply of alcohol**

- (1) No supply of alcohol may be made under the premises licence—
  - (a) at a time when there is no designated premises supervisor in respect of the premises licence, or
  - (b) at a time when the designated premises supervisor does not hold a personal licence or his personal licence is suspended.
- (2) Every supply of alcohol under the premises licence must be made or authorised by a person who holds a personal licence.

### **Mandatory condition where the premises licence includes a Condition that at specified times one or more individuals must be at the premises to carry out a security activity:**

- (1) Each such individual must be licensed by the Security Industry Authority.
- (2) But nothing in (1) above requires such a condition to be imposed—
  - (a) in respect of premises within paragraph 8(3)(a) of Schedule 2 to the Private Security Industry Act 2001 (c. 12) (premises with premises licences authorising plays or films), or
  - (b) in respect of premises in relation to—
    - (i) any occasion mentioned in paragraph 8(3)(b) or (c) of that Schedule (premises being used exclusively by club with club premises certificate, under a temporary event notice authorising plays or films or under a gaming licence), or
    - (ii) any occasion within paragraph 8(3)(d) of that Schedule (occasions prescribed by regulations under that Act).
- (3) For the purposes of this section—
  - (a) “security activity” means an activity to which paragraph 2(1)(a) of that Schedule applies, and
  - (b) paragraph 8(5) of that Schedule (interpretation of references to an occasion) applies as it applies in relation to paragraph 8 of that Schedule.

## **The Licensing Act 2003 (Mandatory Licensing Conditions) Order 2010**

### **With effect from 6<sup>th</sup> April 2010**

1. (1) The responsible person shall take all reasonable steps to ensure that staff on relevant premises do not carry out, arrange or participate in any irresponsible promotions in relation to the premises.

(2) In this paragraph, an irresponsible promotion means any one or more of the following activities, or substantially similar activities, carried on for the purpose of encouraging the sale or supply of alcohol for consumption on the premises in a manner which carries a significant risk of leading or contributing to crime and disorder, prejudice to public safety, public nuisance, or harm to children –

(a) games or other activities which require or encourage, or are designed to require or encourage, individuals to-

(i) drink a quantity of alcohol within a time limit (other than to drink alcohol sold or supplied on the premises before the cessation of the period in which the responsible person is authorised to sell or supply alcohol), or

(ii) drink as much alcohol as possible (whether within a time limit or otherwise);

(b) provision of unlimited or unspecified quantities of alcohol free or for a fixed or discounted fee to the public or to a group defined by a particular characteristic (other than any promotion or discount available to an individual in respect of alcohol for consumption at a table meal, as defined in section 159 of the Act );

(c) provision of free or discounted alcohol or any other thing as a prize to encourage or reward the purchase and consumption of alcohol over a period of 24 hours or less;

(d) provision of free or discounted alcohol in relation to the viewing on the premises of a sporting event, where that provision is dependent on-

(i) the outcome of a race, competition or other event or process, or

(ii) the likelihood of anything occurring or not occurring;

(e) selling or supplying alcohol in association with promotional posters or flyers on, or in the vicinity of, the premises which can reasonably be considered to condone, encourage or glamorise anti-social behaviour or to refer to the effects of drunkenness in any favourable manner.

2. The responsible person shall ensure that no alcohol is dispensed directly by one person into the mouth of another (other than where that other person is unable to drink without assistance by reason of a disability).

3. The responsible person shall ensure that free tap water is provided on request to customers where it is reasonably available.

**With effect from 1<sup>st</sup> October 2010**

4. (1) The premises licence holder or club premises certificate holder shall ensure that an age verification policy applies to the premises in relation to the sale or supply of alcohol.

(2) The policy must require individuals who appear to the responsible person to be under 18 years of age (or such older age as may be specified in the policy) to produce on request, before being served alcohol, identification bearing their photograph, date of birth and a holographic mark.

5. The responsible person shall ensure that –

(a) where any of the following alcoholic drinks is sold or supplied for consumption on the premises (other than alcoholic drinks sold or supplied having been made up in advance ready for sale or supply in a securely closed container) it is available to customers in the following measures –

(i) beer or cider: ½ pint

(ii) gin, rum, vodka or whisky: 25ml or 35ml; and

(iii) still wine in a glass: 125ml; and

(b) customers are made aware of the availability of these measures.

## **Annex 2 - Conditions consistent with the operating Schedule**

### **a) General**

Mantle Brewery Ltd aims to provide a safe and interesting environment to promote the knowledge of beer manufacture and to offer an alternative place of purchase to the public.

### **b) The prevention of crime and disorder**

The brewery will not be operating to a similar manner to a public house with regards to environment, services and hours of operation. Whilst the hours requested for licence may be similar, this is to ensure that the business whose primary objective is the brewing of beer, is flexible to the wants and requirements of potential customers, whilst working around the day to day operations within the brewery. The street trade which occurs in high street pubs is unlikely due to the premises location; this type of night trade will not be encouraged.

### **c) Public safety**

The types of sales likely are as follows and are dealt with as follows:

- Shop sales of bottles and casks for home consumption. Minimal risk to public safety except for injuring due to weight of some packages. Customers will be helped and briefed with heavy packaging
- Brewery tours (on sale). During these events it may be possible for small groups (up to 15 people) to tour the facility escorted. Following the tour, the operational side of the brewery will be closed off to prevent risk of injury from operational areas.
- General on sales will take place in front section of building (up to 50 people at a time), main operational part of brewery will be closed to public at this time for safety reasons.

### **d) The prevention of public nuisance**

General on sales will not be encouraged during weekday hours where other businesses are operating, to ensure noise and public nuisance is mitigated. This would apply to brewery tours and shop sales, the former being a controlled and supervised activity, the latter being a service where customers generally take home the goods purchased.

### **e) The protection of children from harm**

- Challenge 21 will be in place
- Children to be accompanied by adult at all times
- One adult per child ration required on brewery tours
- The facility will not be advertised as child friendly, however children will not be excluded from entry providing supervised by an adult. A brewery tour is an educational activity.

**Annex 3 - Conditions attached after a hearing by the licensing authority/  
Mediation meeting**



# Annex 4 – Plans

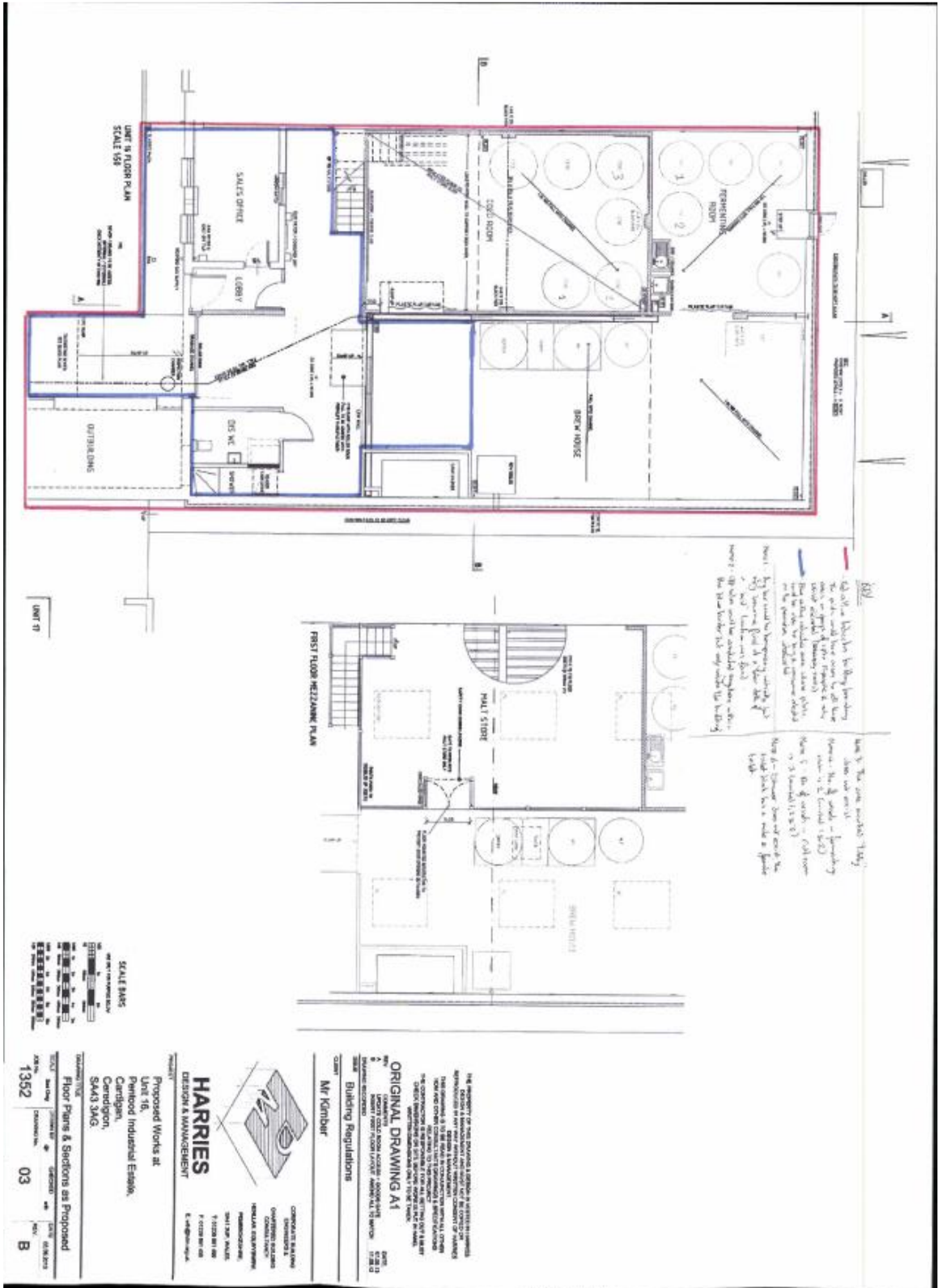

Notes:

- 1. All work shall be carried out in accordance with the Building Regulations.
- 2. The contractor shall ensure that all work is carried out in accordance with the Building Regulations.
- 3. The contractor shall ensure that all work is carried out in accordance with the Building Regulations.

